

CONTROL LINE QUICK SET-UP GUIDELINES

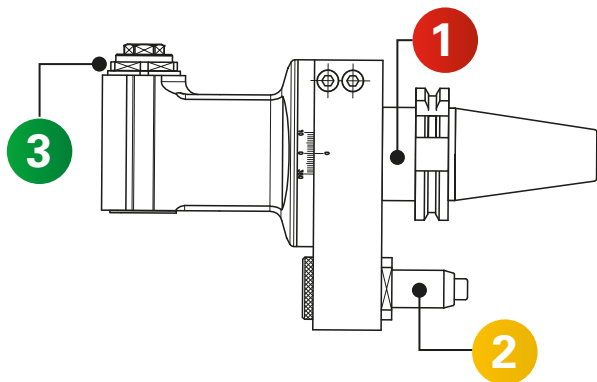

BEFORE USE
CHECK THE TAGS
AND REMOVE THEM STEP BY STEP

1 PREPARATION OF HEAD

STEP 1

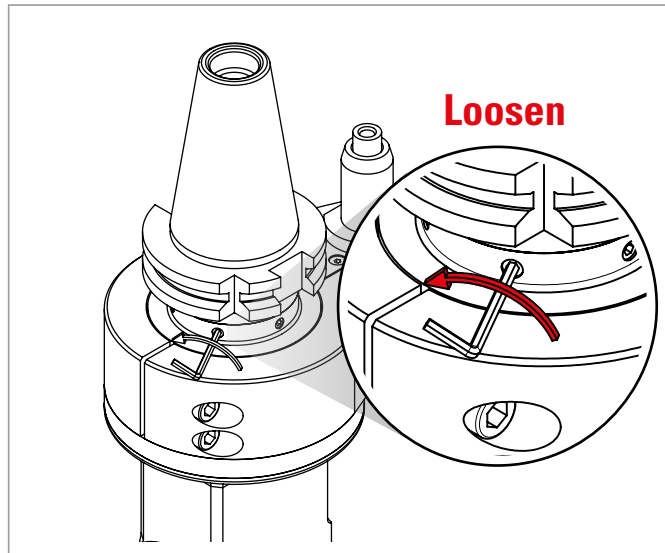

STEP 2

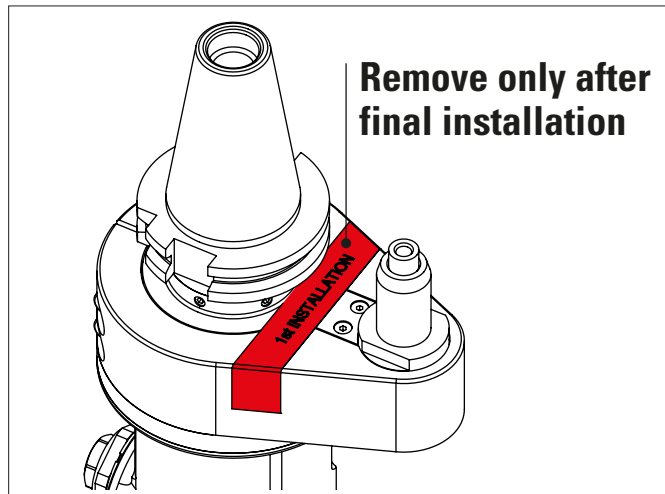

Make sure the pin is inside the notch of orientation ring

2 INSTALLATION OF THE STOP BLOCK

STEP 3

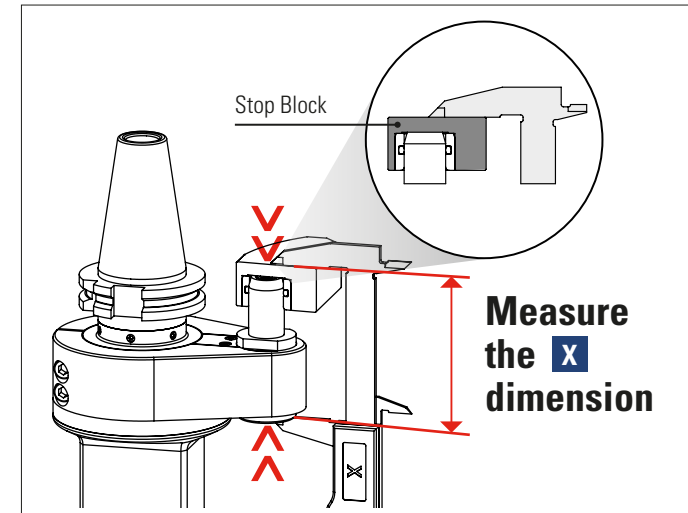

X dimension: _____

STEP 4

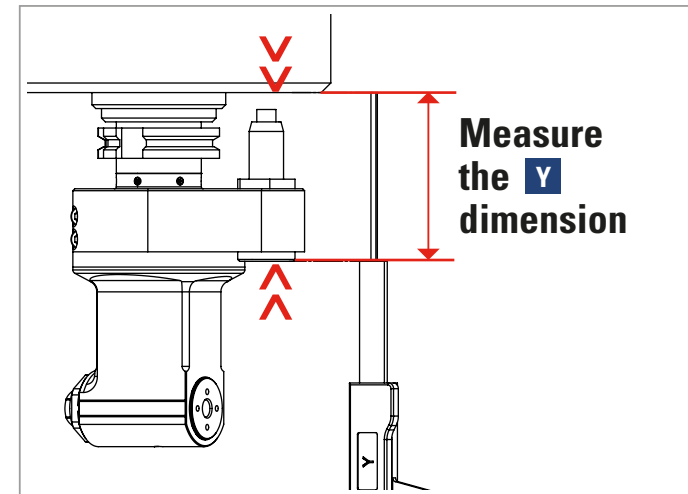

Y dimension: _____

3 FINAL SET UP AND CLAMPING

STEP 5A IF X < Y CREATE A SIMPLE SPACER

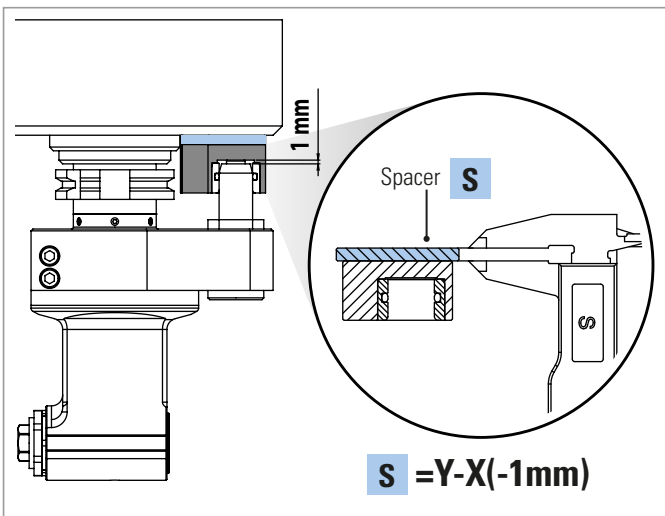

S dimension: _____

STEP 5B IF X > Y REMOVE THE EXCESS AREA

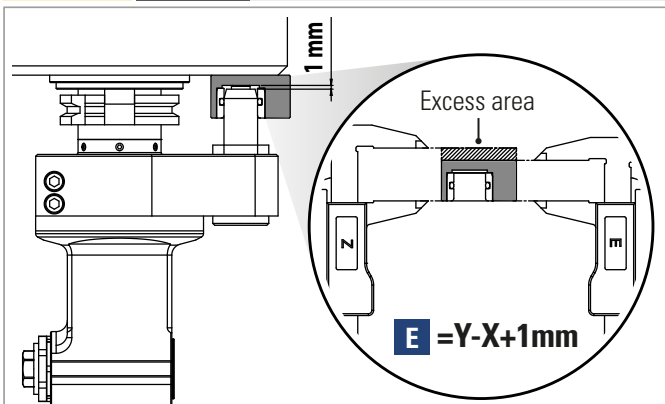

⚠ It's possible to remove max 8 mm.

Z dimension: _____

E dimension: _____

STEP 6 INSERT HEAD INTO MACHINE SPINDLE

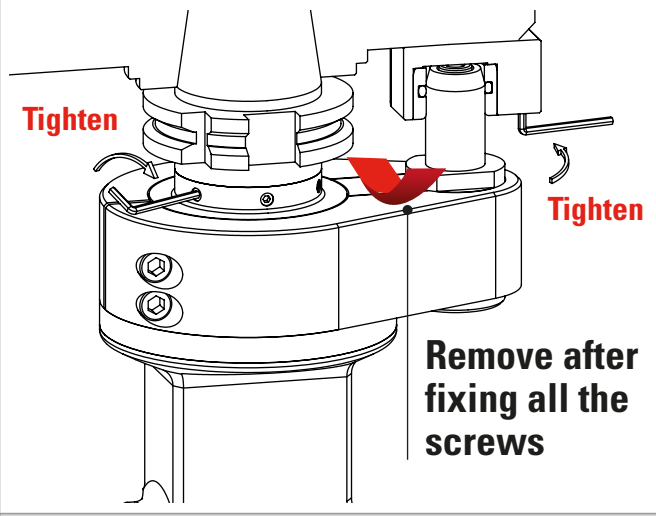

⚠ Spindle position M19

STEP 7

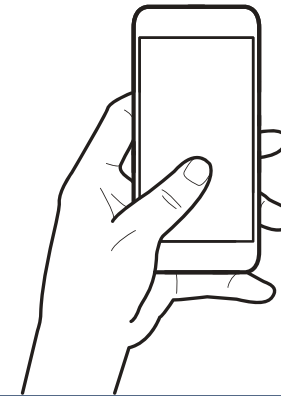
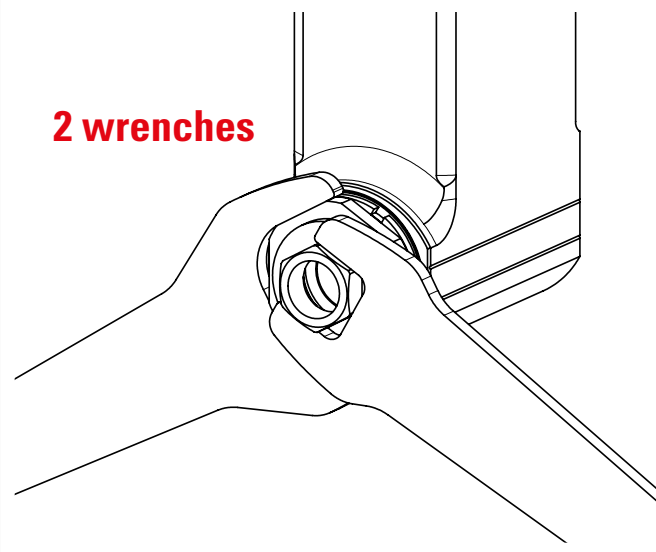

WATCH THE TUTORIAL VIDEO



VISIT WWW.HEADS4FUTURE.COM TO DOWNLOAD THE INSTRUCTIONS



IN CASE OF PROBLEMS OR DOUBTS, PLEASE CONTACT OUR OFFICE



Alberti Umberto S.r.l.
Via Gorizia, 37
21047 Saronno (VA)
Italy

Tel. ++39 0296.703.586
Fax ++39 0296.703.620

info@albertiumberto.com
www.albertiumberto.com