

TR90cn-3,5

ACTR935C



Ratio
Rapporto
1:1



RPM
Velocità
4.000 min⁻¹



Max. axial load
Max. carico assiale
910 N



Torque
Momento torcente
50 Nm



Weight
Peso
10 kg



Collet
Pinza
ER-AX 32 (ø2-20 mm)

* STANDARD EQUIPMENT INCLUDES:



Minimum diameter without tool
Diametro minimo senza utensile

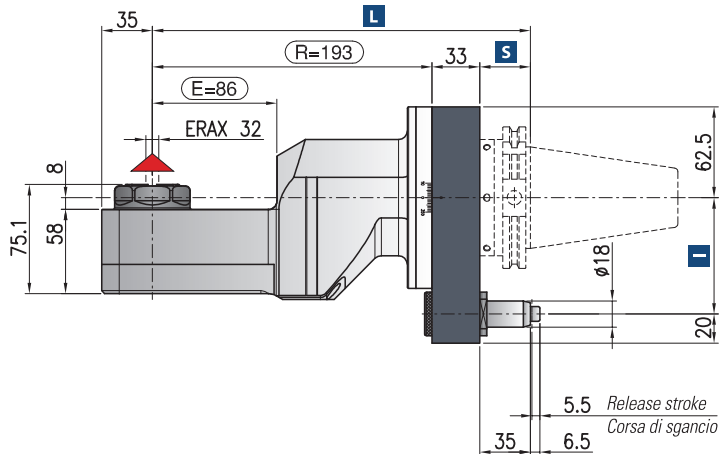
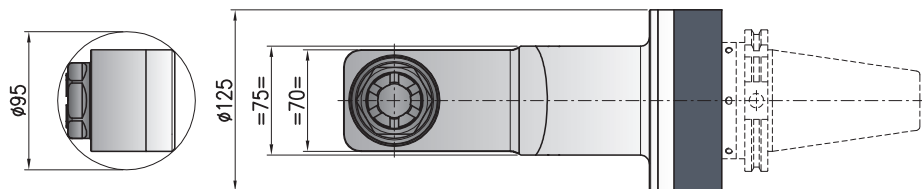

Retaining block / Tassello di ritegno / Stop-Block

NOT INCLUDED - NON INCLUSO



Possibilità refrigerante / Internal coolant / Max. 100 bar

Dry running also possible / Rotazione a secco possibile

▲ Direction of rotation opposite to machine spindle / senso di rotazione contrario al mandrino

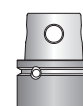
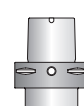
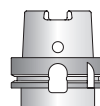
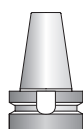
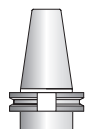
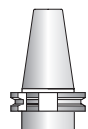

Shank/Cono	DIN-69871		CAT	MAS-BT	HSK		CAPTO		KM
Size/Grandezza	50			50	63-80	100	C6	C8	63
I	80-110			80-110	80-110	80-110	80-110	80-110	80-110
S	35			41	42	45	38	40	40
L	261			267	268	271	264	266	266

Dual contact spindles available/Disponibilità coni a doppio contatto

*optional

Non interchangeable input drive shank/ Coni di attacco non intercambiabili

Opzione / Option



bar max
100

Coolant through spindle
Refrigerante attraverso il cono