



**KOMA PRECISION**  
THE KEY TO PERFORMANCE  
[www.komaprecision.com](http://www.komaprecision.com)

# TSUDAKOMA

## Rotary Table Selection Guide

2022

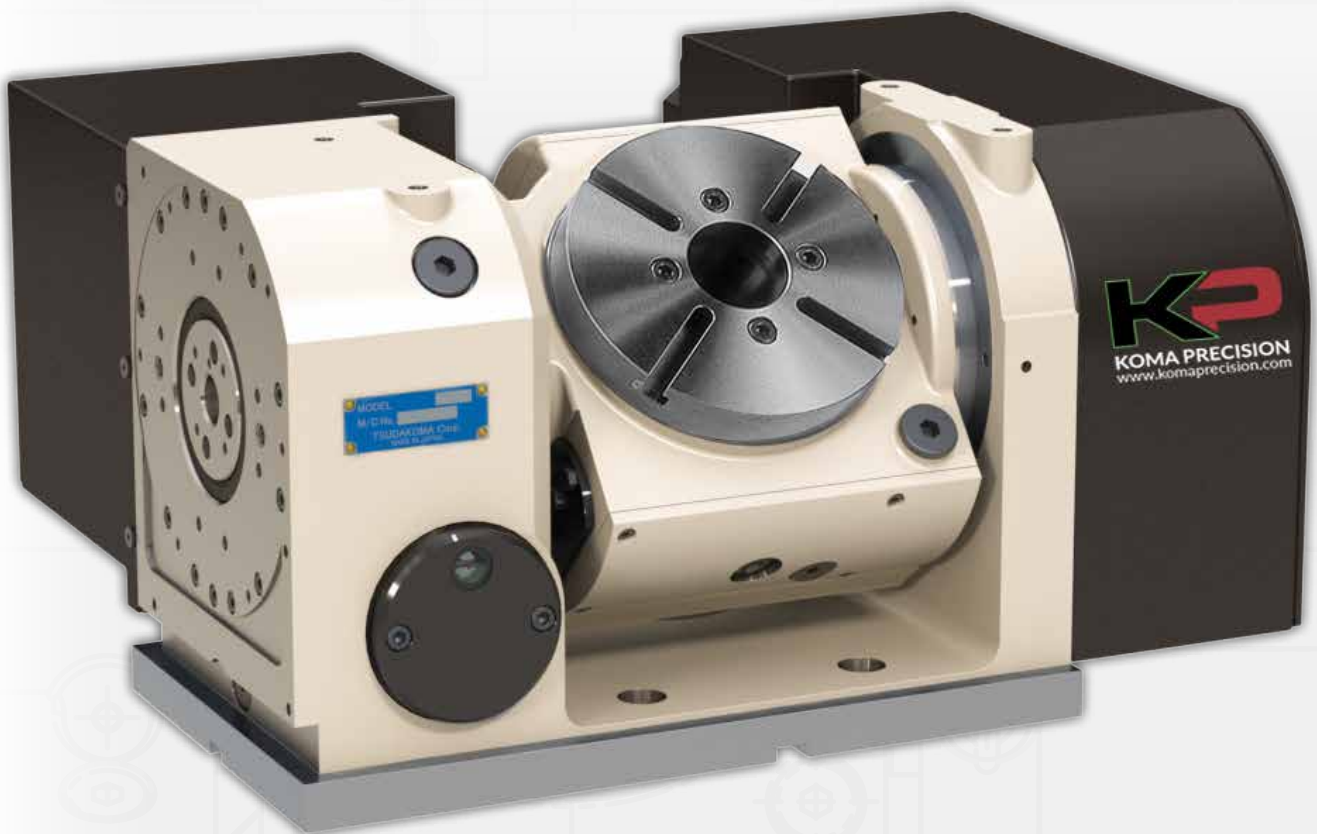

**WE FOCUS ON BEING THE BEST—**  
that's why leading companies choose Koma.

WE ARE THE EXCLUSIVE NORTH AMERICAN  
IMPORTER, NATIONAL DISTRIBUTOR, AND  
SERVICE CENTER FOR TSUDAKOMA ROTARY TABLES.





## KOMA PRECISION

For over forty years Koma Precision has been the foremost source for the finest the world has to offer in machine tool Productivity Innovation.

With over 30,000 rotary table installations, Koma is the largest distributor of Tsudakoma NC rotary tables and indexers in the world. With over 12,000 angle heads and live tools installed, Koma is the world's largest supplier for Alberti - the originator and the foremost innovator of productivity tooling.



# 4<sup>th</sup> AXIS ROTARY TABLE SPECIFICATIONS

## Rotary Table Dimensions

Reference Only • Detailed drawings available upon request

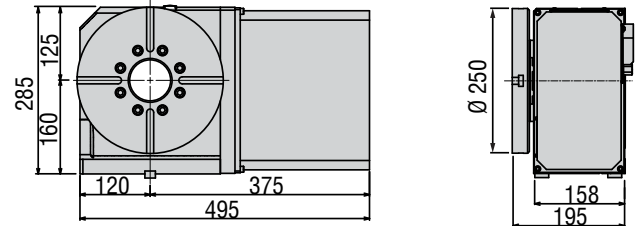

## Options & Accessories

Additional Accessories Available

Manual Tailstock w/ MT3 Center  
(TL-160M)



3-Jaw Scroll Chucks  
10" (EZ-103)



Support Spindle w/  
Pneumatic Clamp  
(TS-160P)



Support Spindle  
(TS-160)



Rotary Joint  
6-port | Hydraulic | 3,000 psi

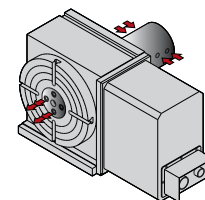
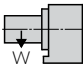
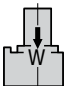
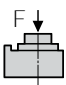
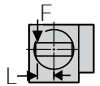
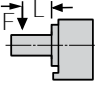

Table Model		RWA-250R,M	
Spindle outer diameter		140h7	
Table diameter (optional)		250	
Center height		160	
Center bore	Nose Diameter	80H7	
	Thru Diameter	50	
Table T-slot width (with faceplate)		12H8	
Guide block width		18h7	
Servo motor		Alpha 8i	
Maximum motor speed		rpm	4,000
Speed reduction ratio		1/90	
Maximum table speed		rpm	44.4
Inertia converted into motor shaft $\times 10^{-3}\text{kg}\cdot\text{m}^2$		.41	
Clamp system		Pneumatic Dual Taper	
Clamp torque @72psi		Nm (ft. lbs.)	1,000 (737)
Indexing accuracy		arc sec.	$\pm 10$
Net Weight		kg (lbs.)	80 (176)
Allowable wheel torque		Nm (ft. lbs.)	596 (439)
Allowable work inertia		kg·m <sup>2</sup>	1.95
Allowable work weight		kg (lbs)	125 (275) [250 (550)]
		kg (lbs)	250 (550)
Allowable load when table clamped		N (lbf)	14,400 (3,226)
		Nm (ft. lbs.)	1,000 (737)
		Nm (ft. lbs.)	1,900 (1,400)

Specifications subject to change without notice

• Dimensions = mm



## PS65 / PS105



## RWA-250R,M

Compact. Massive clamp torque.

# 5<sup>th</sup> AXIS ROTARY TABLE SPECIFICATIONS

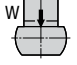
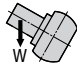
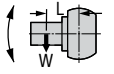
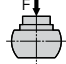
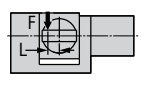
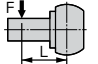
Model		TWA-160,M	
Tilt Range		-30° ~ +110°	
Spindle outer diameter		100h7	
Table diameter (optional)		(160 or 200)	
Table height at 0° position		235 (260 w/faceplate)	
Center height at 90° position		180	
Center bore	Nose Diameter (w/faceplate)	55H7 (50H7)	
	Thru Diameter	40	
Table T-slot width		12H8 (w/faceplate)	
Guide block width		18h7	
Servo motor*	Rotary	Alpha 2i	Tilt
		Alpha 2i	Alpha 2i
Maximum motor speed	rpm	5,000	5,000
Speed reduction ratio		1/72	1/120
Maximum table speed	rpm	69.4	41.7
Inertia converted into motor shaft	x 10 <sup>-3</sup> kg·m <sup>2</sup>	.17	.18
Clamp system		Pneumatic Dual Taper	Pneumatic Dual Taper
Clamp torque @72psi	Nm (ft. lbs.)	500 (369)	800 (590)
Indexing accuracy	arc sec.	±15	-
Tilting accuracy	arc sec.	-	±22.5
Net Weight	kg (lbs.)	127 (279)	
Allowable wheel torque - rotary	Nm (ft. lbs.)	200 (147)	
Allowable work inertia	kg·m <sup>2</sup>	.19	
Allowable work weight kg (lbs)		0° tilt angle	60 (132)
		0° ~ 90° tilt angle	40 (88)
Allowable work moment		Nm (ft. lbs.)	39.2 (28.9)
Allowable load when table clamped		N (lbf)	7,840 (1,756)
		Nm (ft. lbs.)	500 (369)
		Nm (ft. lbs.)	800 (590)

Specifications subject to change without notice • Dimensions = mm

## Rotary Table Dimensions

Reference Only • Detailed drawings available upon request

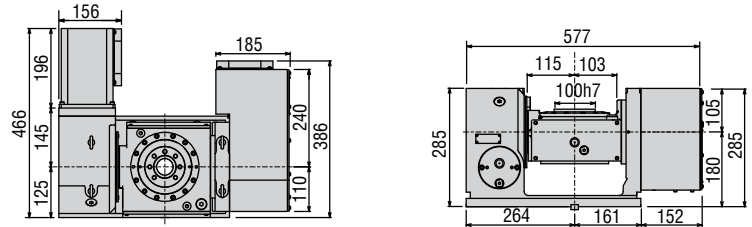

## Options & Accessories

Additional Accessories Available

### T-Slotted Faceplates

160mm  
200mm



### 3-Jaw Scroll Chucks

6" - (EZ-63)



### Rotary Joint

6-port | Hydraulic | 3,000 psi

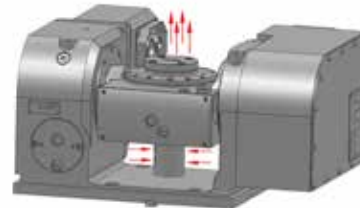

## TWA-Series Monoblock Construction

All new TWA-Series tilting rotary tables feature Tsudakoma's Monoblock one piece casting construction. Monoblock construction results in tilting tables with superior rigidity and damping characteristics, which translates into parts with smoother surface finishes. Tsudakoma is the only rotary table manufacturer with its own casting foundry.



**PS65 / PS105**



**TWA-160,M**

Powerful, High Speed Tilting Tables.



# UNLOCK YOUR POTENTIAL TODAY!

For Over 40 years Koma Precision Inc. has partnered with Tsudakoma and Alberti, to become the North American leader in machine tool accessories. Both Tsudakoma and Alberti machine tool accessories are built to the highest standards and set the bar for excellence, quality, and performance.

Koma Precision has an installation base of over 30,000 Tsudakoma rotary tables and 25,000 Alberti angle heads and live tools, leading the way with knowledge and experience.

## **Knowledge and Experience Matter.**

Our three facilities totaling 40,000 sq/ft, feature a full machine shop, state-of-the-art inspection and test equipment, and product demonstration showroom. Our Connecticut based headquarters also houses our multi-million-dollar inventory of new products and spare parts.



20 Thompson Road  
East Windsor, CT 06088

Tel: 1.800.249.5662  
Fax: 860.623.4132  
[info@komaprecision.com](mailto:info@komaprecision.com)



**KOMA PRECISION**  
[www.komaprecision.com](http://www.komaprecision.com)

