



**KOMA PRECISION**  
THE KEY TO PERFORMANCE  
[www.komaprecision.com](http://www.komaprecision.com)

 **Alberti**

# ANGLE HEAD Selection Guide

2022



**WE FOCUS ON BEING THE BEST—**  
that's why leading companies choose Koma.

WE ARE THE EXCLUSIVE NORTH AMERICAN  
IMPORTER, NATIONAL DISTRIBUTOR, AND  
SERVICE CENTER FOR ALBERTI ANGLE HEADS.

**brother®**

**MINILINE TURBODRILL**

## KOMA PRECISION

---

For over forty years Koma Precision has been the foremost source for the finest the world has to offer in machine tool Productivity Innovation.

With over 30,000 rotary table installations, Koma is the largest distributor of Tsudakoma NC rotary tables and indexers in the world. With over 12,000 angle heads and live tools installed, Koma is the world's largest supplier for Alberti - the originator and the foremost innovator of productivity tooling.



# MINILINE 1.5



With over 12,000 angle heads and live tools installed, KOMA Precision is the world's largest supplier for ALBERTI - the originator and the foremost innovator of productivity tooling.

## ALBERTI: A COMPLETE RANGE OF PRODUCTIVITY TOOLING WITHOUT COMPARISON

ALBERTI has been manufacturing angle heads since 1986. Within a few years ALBERTI tooling became internationally renowned for precision, quality, and reliability. Available tools include over 50 different types of standard angle heads and more than 250 types of standard live tools. ALBERTI innovation and passion for perfection has made it the world leader in precision tooling.

# MINILINE

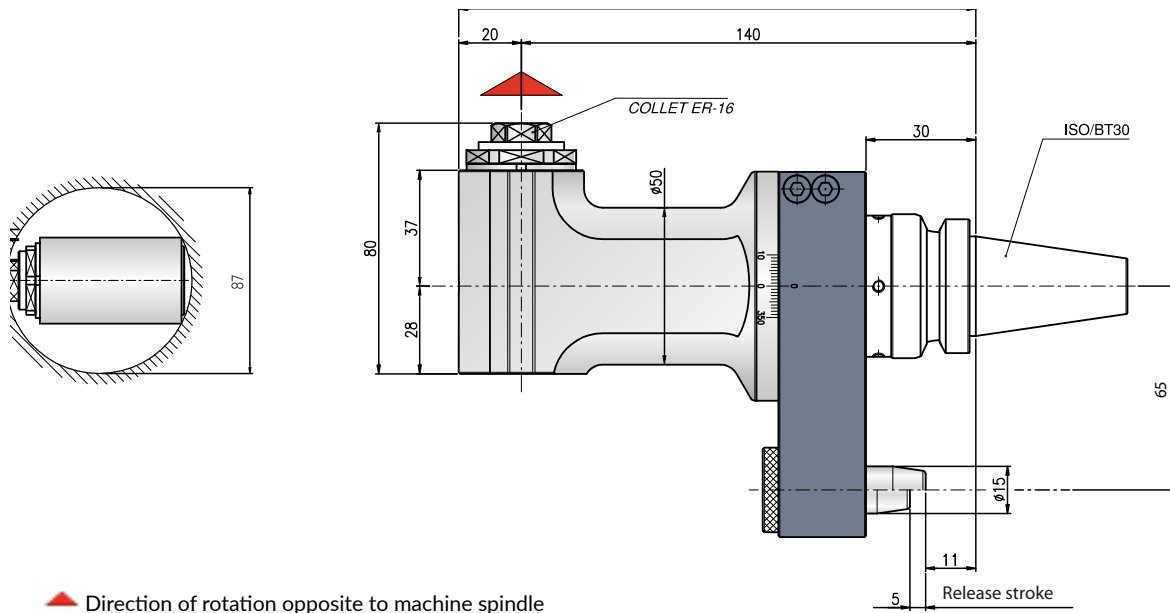

## MINILINE 1.5

Lightweight Body  
Spindle Driven

Max. RPM 6,000 RPM  
Max. Tool Capacity 10 mm  
DRILLING | MILLING | TAPPING

## TECHNICAL DATA

Miniline 1.5 / 30			
Tool RPM maximum	6,000	Ratio	1/1
Max. Axial load	250 N	Torque	7 Nm
Weight	6.6 lbs	Collet	ER-16 $\varnothing$ 1/10 mm

Included with Tool: Storage Case • Wrenches • Grease  
Instruction Manual

# ALUMINUM

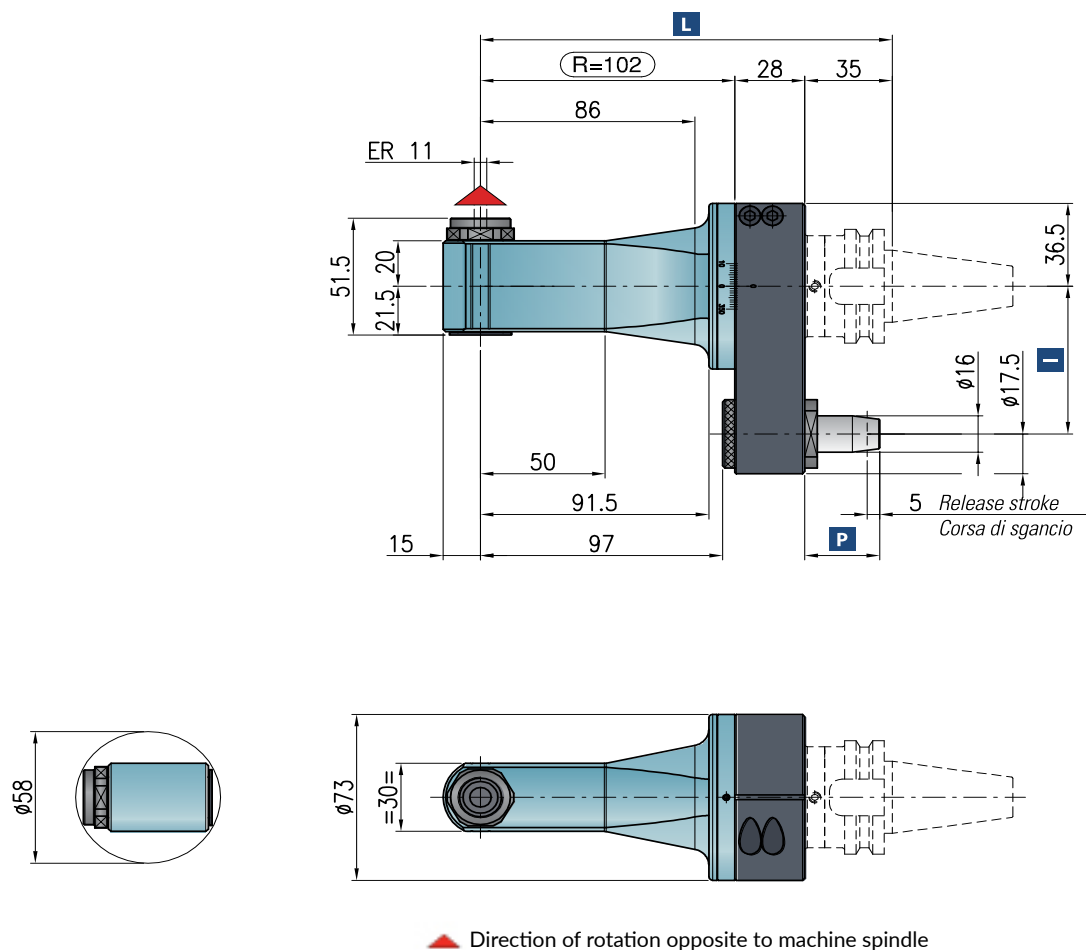

## TECHNICAL DATA

ALUMINUM T90cn-0.5M			
Tool RPM maximum	10,000	Ratio	1/1
Max. Axial load	120 N	Torque	8 Nm
Weight	5.95 lbs	Collet	ERAX-11 (0.5-7 mm)

Included with Tool: Storage Case • Wrenches • Grease  
Instruction Manual

## ALUMINUM T90CN-0.5M

Lightweight Body  
Spindle Driven

Max. RPM 10,000 RPM  
DRILLING | MILLING | TAPPING

# ALUMINUM

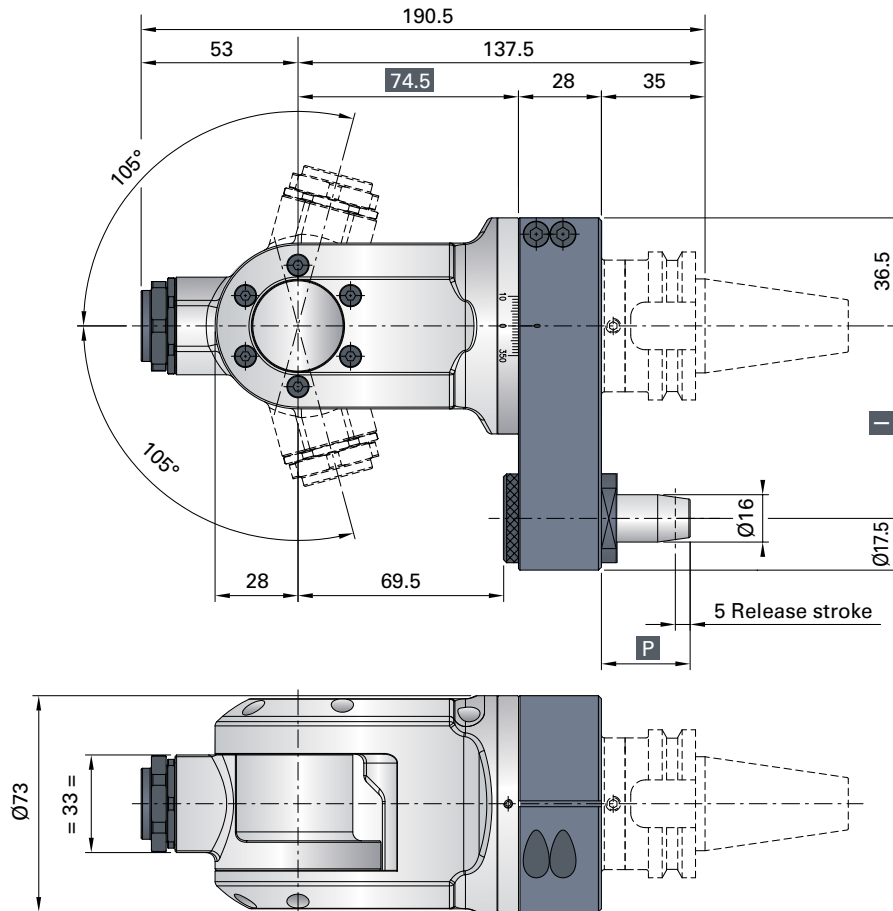

▲ Direction of rotation opposite to machine spindle

## ALUMINUM TCUcn-0.5M

Lightweight Body  
Spindle Driven

Max. RPM 6,000 RPM  
DRILLING | MILLING | TAPPING

## TECHNICAL DATA

ALUMINUM TCUcn-0.5M			
<b>Tool RPM maximum</b>	6,000	<b>Ratio</b>	1:1.5 (Speeder)
<b>Max. Axial load</b>	215 N	<b>Torque</b>	8 Nm
<b>Weight</b>	6.17 lbs	<b>Collet</b>	ERAX-11 (0.5-7 mm)

Included with Tool: Storage Case • Wrenches • Grease Instruction Manual

# SLIMLINE

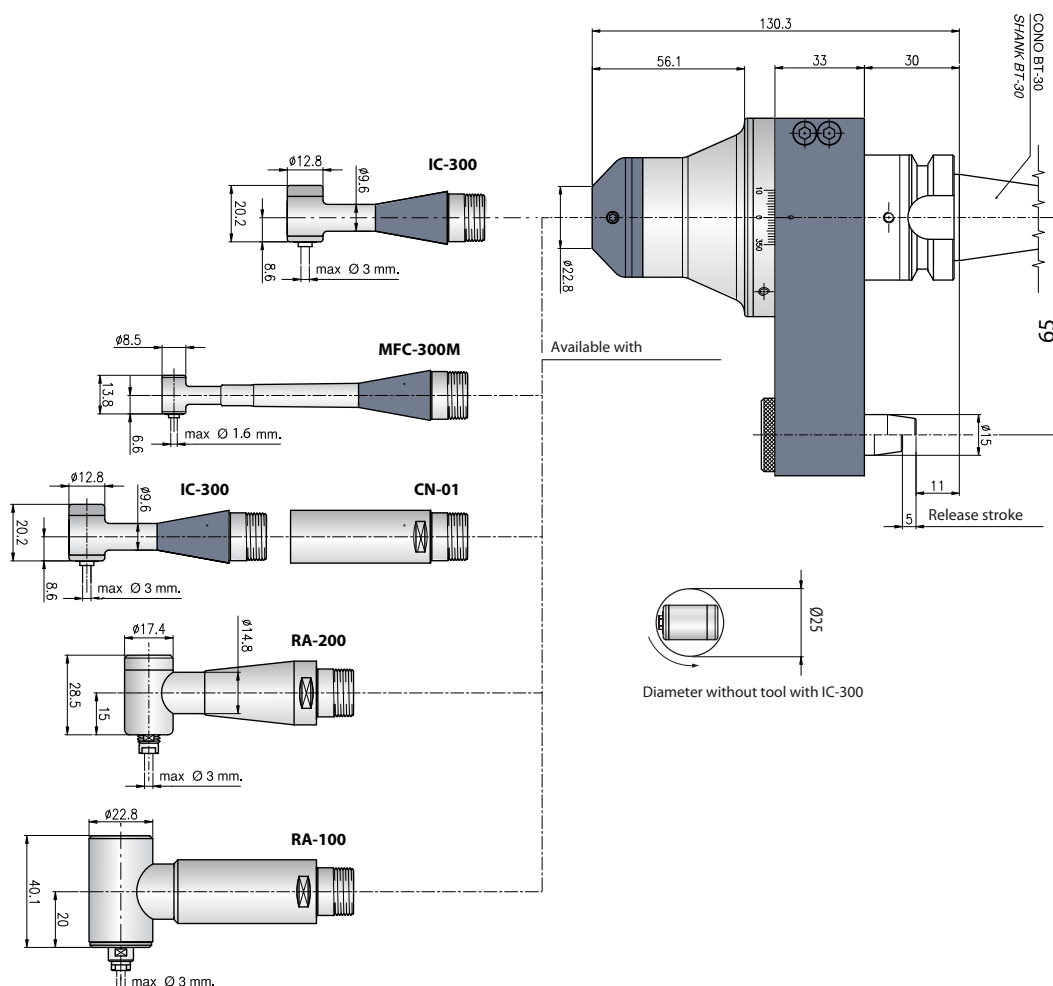

## TECHNICAL DATA

IC-300 *			
Tool RPM maximum	20,000	Reduction Ratio	3/4
Collet	CHM Ø3	Type Spindle	IC-300
Rotation	Right, left	Weight	6.6 lbs

Included with Tool: Storage Case • Wrenches • Grease • Instruction Manual  
\*For special applications only

## SLIMLINE

Spindle Driven

Max. RPM 20,000 RPM  
Max. Tool Capacity 3 mm  
ENGRAVING | LIGHT MILLING

# TURBODRILL

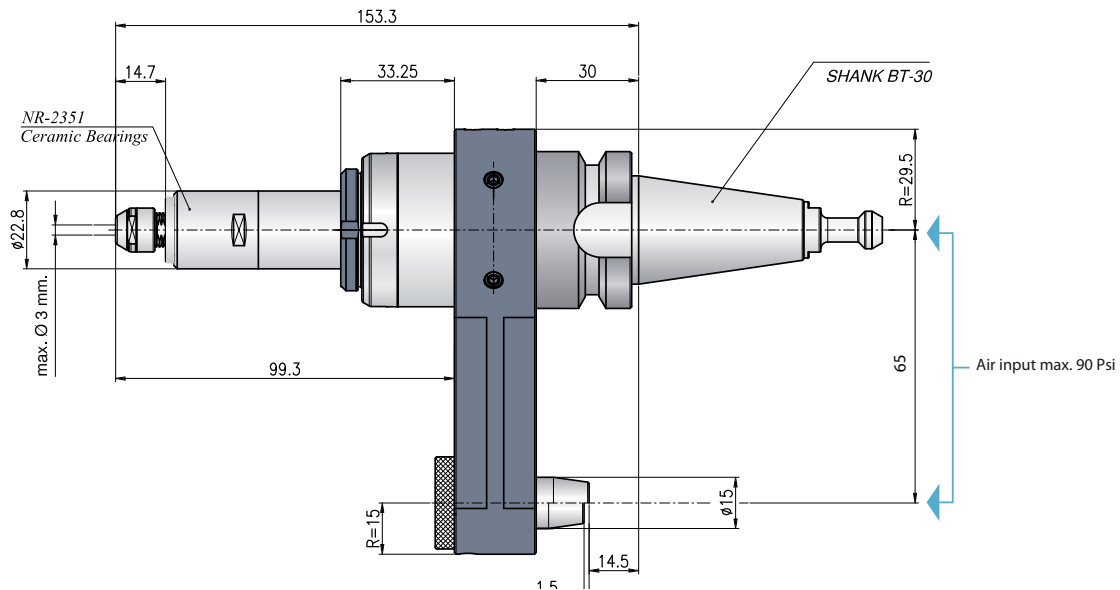

## TURBODRILL NR-2351

Compact Ultra High Speed | Air Driven  
Axial model with air supplied through the spindle or stop block

Max. RPM 58,000 RPM  
Max. Tool Capacity 3 mm  
ENGRAVING | LIGHT MILLING

## TECHNICAL DATA

NR-2351			
Tool RPM maximum	58,000	Reduction Ratio	--
NSK Output RPM	58,000	Air Pressure	90 psi max.
Air Motor	AM-600	Air Consumption	5.65 cfm
NSK Output Tool		Weight	4.1 lbs
Power	0.10 HP	Collet	CHK $\varnothing$ 3

Included with Tool: Storage Case • Wrenches • Grease • Instruction Manual



# TURBODRILL

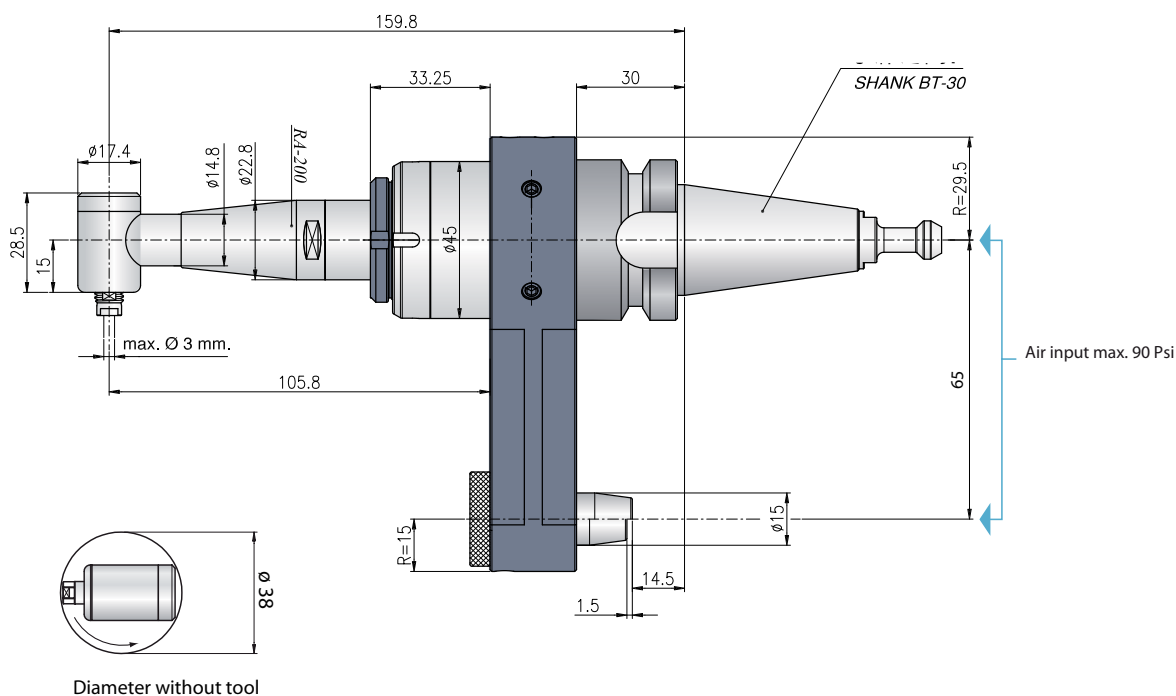

## TECHNICAL DATA

TD-RA-200			
Tool RPM maximum	30,000	Reduction Ratio	1/1.5
NSK Output RPM	20,000	Air Pressure	90 psi max.
Air Motor	AM-310	Air Consumption	7.98 cfm
NSK Output Tool	RA-200	Weight	4.1 lbs
Power	0.14 HP	Collet	CHS ø 3

Included with Tool: Storage Case • Wrenches • Grease • Instruction Manual

## TURBODRILL TD-RA-200

Compact Ultra High Speed  
Air Driven

Axial model with air supplied  
through the spindle or stop block

Max. RPM 30,000 RPM  
Max. Tool Capacity 3 mm  
ENGRAVING | LIGHT MILLING

## COLLETS

### CHS (for TD-RA-200)

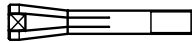

Model	Inside Diameter (mm)
GP-59027-00	0.8
GP-59028-00	0.9
GP-59029-00	1.0
GP-59030-00	1.1
GP-59031-00	1.2
GP-59032-00	1.3
GP-59033-00	1.4
GP-59034-00	1.5
GP-59012-00	1.6
GP-59035-00	1.7
GP-59036-00	1.8
GP-59037-00	1.9
GP-59016-00	2.0
GP-59038-00	2.1
GP-59039-00	2.2
GP-59040-00	2.3
GP-59041-00	2.35
GP-59042-00	2.4
GP-59013-00	2.5
GP-59043-00	2.6
GP-59044-00	2.7
GP-59045-00	2.8
GP-59046-00	2.9
GP-59009-00	3.0
GP-59011-00	3.175

### CHC (for IC-300, KC-300)



Model	Inside Diameter (mm)
GP-59021-00	1.6
GP-59024-00	2.35
GP-59015-00	3.0
GP-59010-00	3.175

## COLLETS

### CHM (for TDS-NR-601 • TD-NR-601/601-30)



Model	Inside Diameter (mm)
GP-59073-00	0.3
GP-59074-00	0.4
GP-59075-00	0.5
GP-59076-00	0.6
GP-59077-00	0.7
GP-59078-00	0.8
GP-59079-00	0.9
GP-59080-00	1.0
GP-59081-00	1.1
GP-59082-00	1.2
GP-59083-00	1.3
GP-59084-00	1.4
GP-59085-00	1.5
GP-59086-00	1.6
GP-59087-00	1.7
GP-59088-00	1.8
GP-59089-00	1.9
GP-59090-00	2.0
GP-59091-00	2.1
GP-59092-00	2.2
GP-59093-00	2.3
GP-59094-00	2.35
GP-59095-00	2.4
GP-59096-00	2.5
GP-59097-00	2.6
GP-59098-00	2.7
GP-59099-00	2.8
GP-59100-00	2.9
GP-59101-00	3.0
GP-59102-00	3.175

# MINILINE STOP BLOCK

## BROTHER TC-32



I	80
P	30

## BROTHER S2D



I	80
P	24

## BROTHER S500 S700 S1000



I	80
P	25,75

## BROTHER R450X1



I	50
P	24

## AIR LINE KIT *For Turbodrill only*

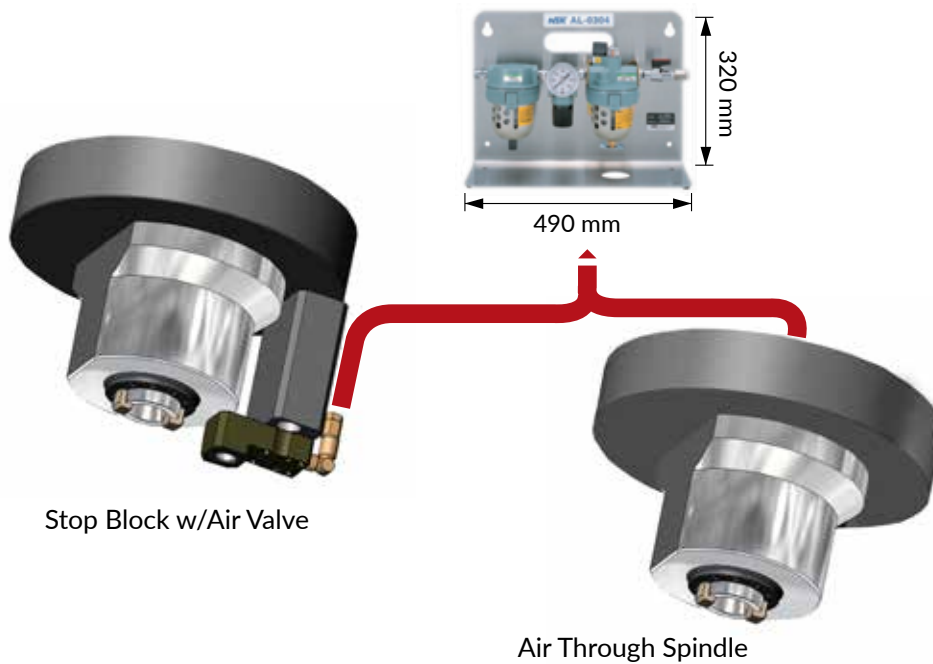

# UNLOCK YOUR POTENTIAL TODAY!

For Over 40 years Koma Precision Inc. has partnered with Tsudakoma and Alberti, to become the North American leader in machine tool accessories. Both Tsudakoma and Alberti machine tool accessories are built to the highest standards and set the bar for excellence, quality, and performance.

Koma Precision has an installation base of over 30,000 Tsudakoma rotary tables and 25,000 Alberti angle heads and live tools, leading the way with knowledge and experience.

## **Knowledge and Experience Matter.**

Our three facilities totaling 40,000 sq/ft, feature a full machine shop, state-of-the-art inspection and test equipment, and product demonstration showroom. Our Connecticut based headquarters also houses our multi-million-dollar inventory of new products and spare parts.



20 Thompson Road  
East Windsor, CT 06088

Tel: 1.800.249.5662  
Fax: 860.623.4132  
[info@komaprecision.com](mailto:info@komaprecision.com)



**KOMA PRECISION**  
[www.komaprecision.com](http://www.komaprecision.com)

