

TR90cn-0,4

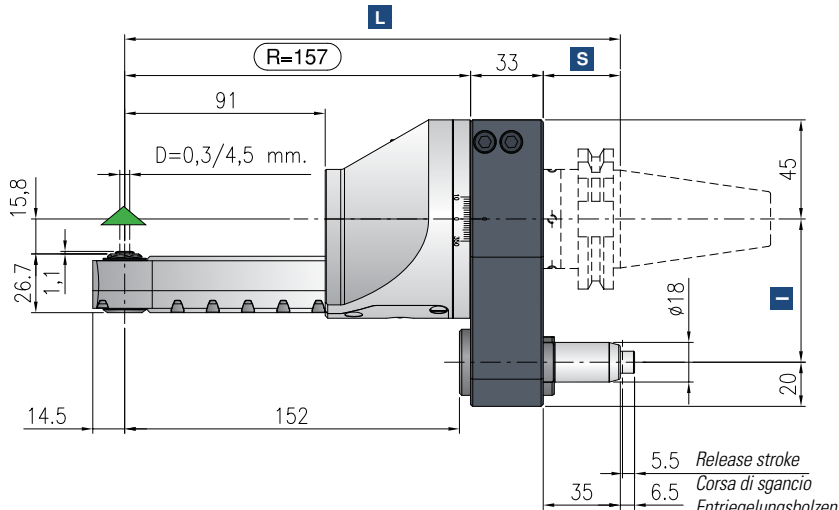

Minimum diameter without tool
 Diametro minimo senza utensile
 Durchmesser min. ohne Werkzeug

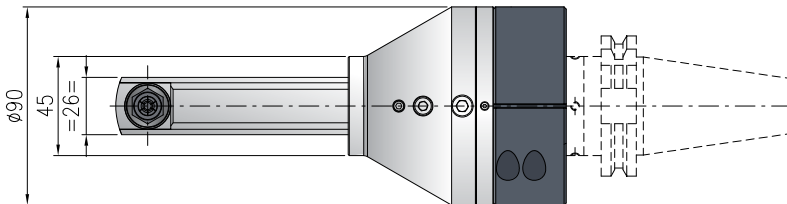
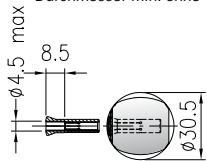

Ratio
 Rapporto / Verhältnis
2.375:1



RPM
 Velocità / Drehzahl max.
3.500 min⁻¹



Max. axial load
 Max. carico assiale / Max. Axialbelastung
135 N



Torque
 Momento torcente / Drehmoment
8 Nm



Weight
 Peso / Gewicht
4.5 kg



Collet
 Pinza / Spannzange
SCHAUBLIN P6

*** STANDARD EQUIPMENT INCLUDES:**

- Special bag - wrenches - Grease tube - Instruction book
- Bauletto - Ghiera ER chiavi di servizio - Tubetto di grasso - Libro istruzioni
- Spezialtasche - Schraubenschlüssel - Tube mit Fett - Bedienungsanleitung

▲ Direction of rotation same as machine spindle / senso di rotazione uguale al mandrino / Drehrichtung gleich wie Antriebsspindel

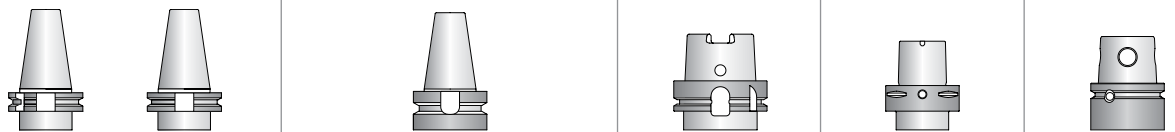

Shank/Cono/Aufnahme	DIN-69871		MAS-BT			HSK		CAPTO		KM
Size/Grandezza/Größe	40	50	30	40	50	63-80	100	C5-C6	C8	50-63
I	65-80-(110*)	80-(110*)	65-80	65-80-(110*)	80-(110*)	65-80-(110*)	80-(110*)	65-80-(110*)	80-(110*)	65-80-(110*)
S	35	35	30	35	41	42	45	38	40	40
L	170	170	165	170	176	177	180	173	175	175

*optional

Non interchangeable input drive shank/ Coni di attacco non intercambiabili/ Nicht wechselbare Aufnahme

Option / Opzione / Option



bar max

12

Coolant through pin
 Adduzione refrigerante attraverso il perno
 Kühlmittelzufuhr durch Bolzen

TR90cn-1,5



Ratio
Rapporto / Verhältnis
1: 1,5 speeder



RPM
Velocità / Drehzahl max.
8.000 min⁻¹



Max. axial load
Max. carico assiale / Max. Axialbelastung
350 N



Torque
Momento torcente / Drehmoment
15 Nm



Weight
Peso / Gewicht
7 kg



Collet
Pinza / Spannzange
ER-AX / ø1-10 mm

*** STANDARD EQUIPMENT INCLUDES:**

- Special bag - wrenches - Grease tube - Instruction book
- Bauletto - Ghiera ER chiavi di servizio - Tubetto di grasso - Libro istruzioni
- Spezialtasche - Schraubenschlüssel - Tube mit Fett - Bedienungsanleitung

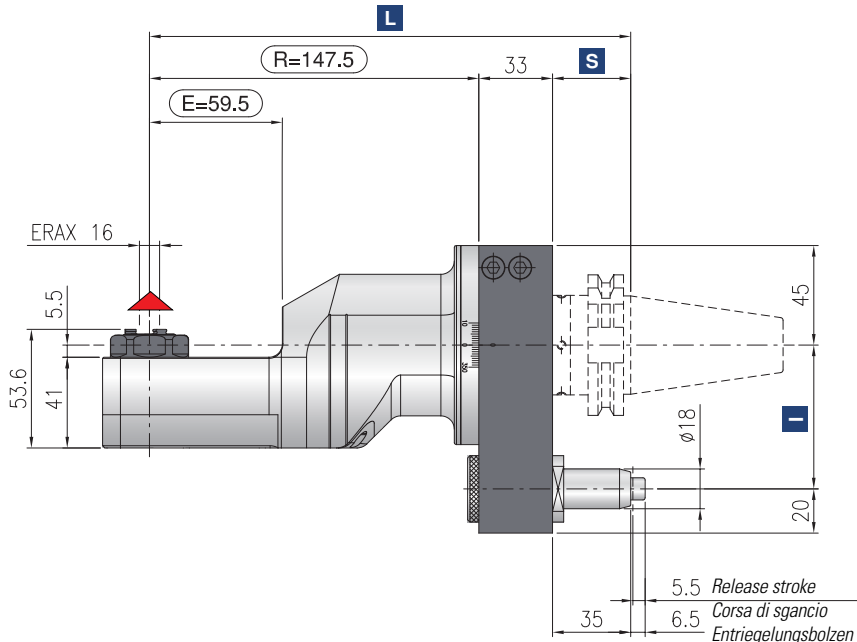
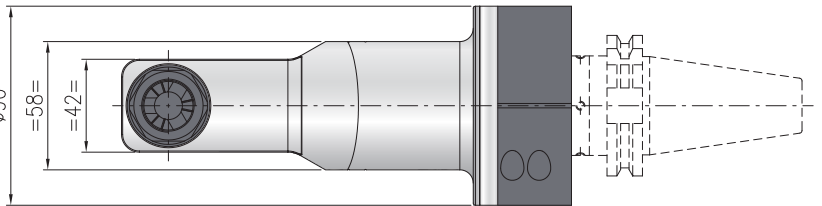
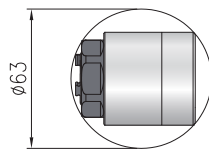

Possibilità refrigerante / Internal coolant / Innere Kühlmittelzufuhr - Max. 100 bar

▲ Direction of rotation opposite to machine spindle / senso di rotazione contrario al mandrino / Drehrichtung entgegen Antriebsspindel

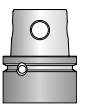
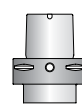
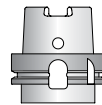
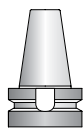
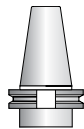
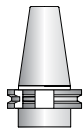

Shank/Cono/Aufnahme	DIN-69871	CAT	MAS-BT		HSK		CAPTO		KM
Size/Grandezza/Größe	40	50	40	50	63-80	100	C5-C6	C8	63
I	65-80	80-(110*)	65-80-(110*)	80-(110*)	65-80-(110*)	80-(110*)	65-80-(110*)	80-(110*)	65-80-(110*)
S	35	35	35	41	42	45	38	40	40
L	150	150	150	156	157	160	153	155	155

*optional

Non interchangeable input drive shank/ Coni di attacco non intercambiabili/ Nicht wechselbare Aufnahme

Option / Opzione / Option



bar max

12

Coolant through pin
Refrigerante attraverso il perno
Kühlmittelzufuhr durch Bolzen

TR90cn-2,5

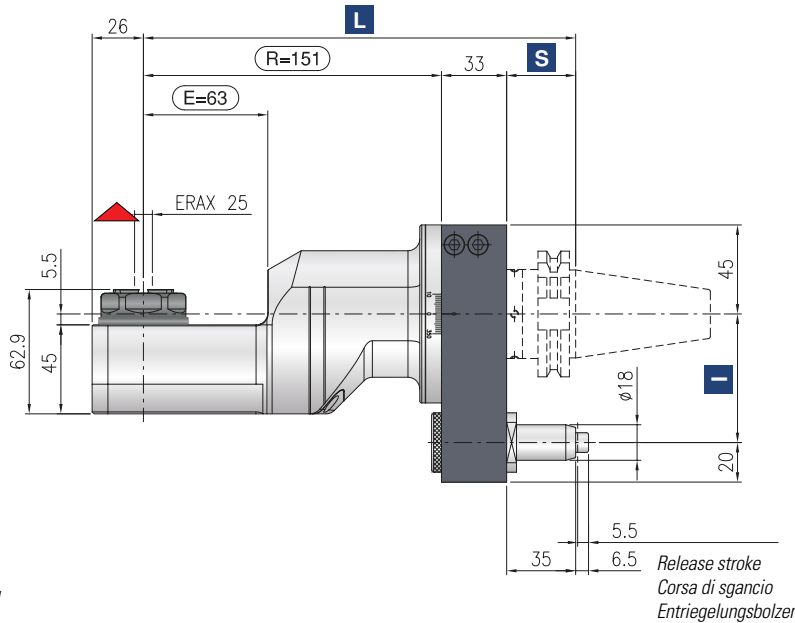

Minimum diameter without tool
 Diametro minimo senza utensile
 Durchmesser min. ohne Werkzeug

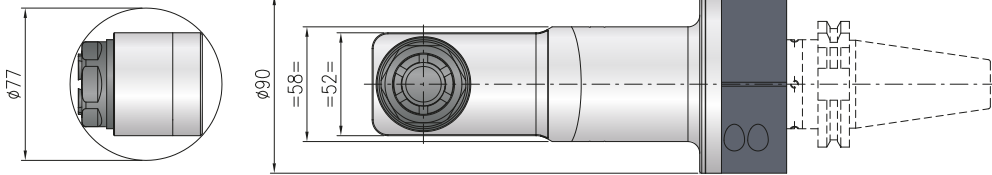

Ratio
 Rapporto / Verhältnis
1:1



RPM
 Velocità / Drehzahl max.
6000 min⁻¹



Max. axial load
 Max. carico assiale / Max. Axialbelastung
510 N



Torque
 Momento torcente / Drehmoment
30 Nm



Weight
 Peso / Gewicht
7.5 kg



Collet
 Pinza / Spannzange
ER-AX 25 (Ø1-16mm)

*** STANDARD EQUIPMENT INCLUDES:**

- Special bag - wrenches - Grease tube - Instruction book
- Bauletto - Ghiera ER chiavi di servizio - Tubetto di grasso - Libro istruzioni
- Spezialtasche - Schraubenschlüssel - Tube mit Fett - Bedienungsanleitung



Possibilità refrigerante / Internal coolant / Innere Kühlmittelzufuhr - Max. 100 bar

▲ Direction of rotation opposite to machine spindle / senso di rotazione contrario al mandrino / Drehrichtung entgegen Antriebsspindel

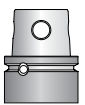
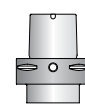
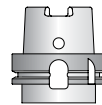
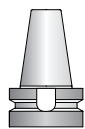
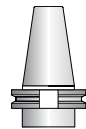
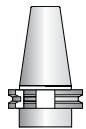

Shank/ Cono/ Aufnahme	DIN-69871	CAT	MAS-BT		HSK		CAPTO		KM
Size/ Grandezza/ Größe	40	50	40	50	63-80	100	C5-C6	C8	50-63
I	65-80-(110*)	80-(110*)	65-80-(110*)	80-(110*)	65-80-(110*)	80-(110*)	65-80-(110*)	80-(110*)	65-80-(110*)
S	35	35	35	41	42	45	38	40	40
L	216	216	216	222	223	226	219	221	221

*optional

Non interchangeable input drive shank/ Coni di attacco non intercambiabili/ Nicht wechselbare Aufnahme

Option / Opzione / Option



bar max

12

Coolant through pin
 Adduzione refrigerante attraverso il perno
 Kühlmittelzufuhr durch Bolzen